

2024 NORTHEAST JOINT SUMMER AGENDA

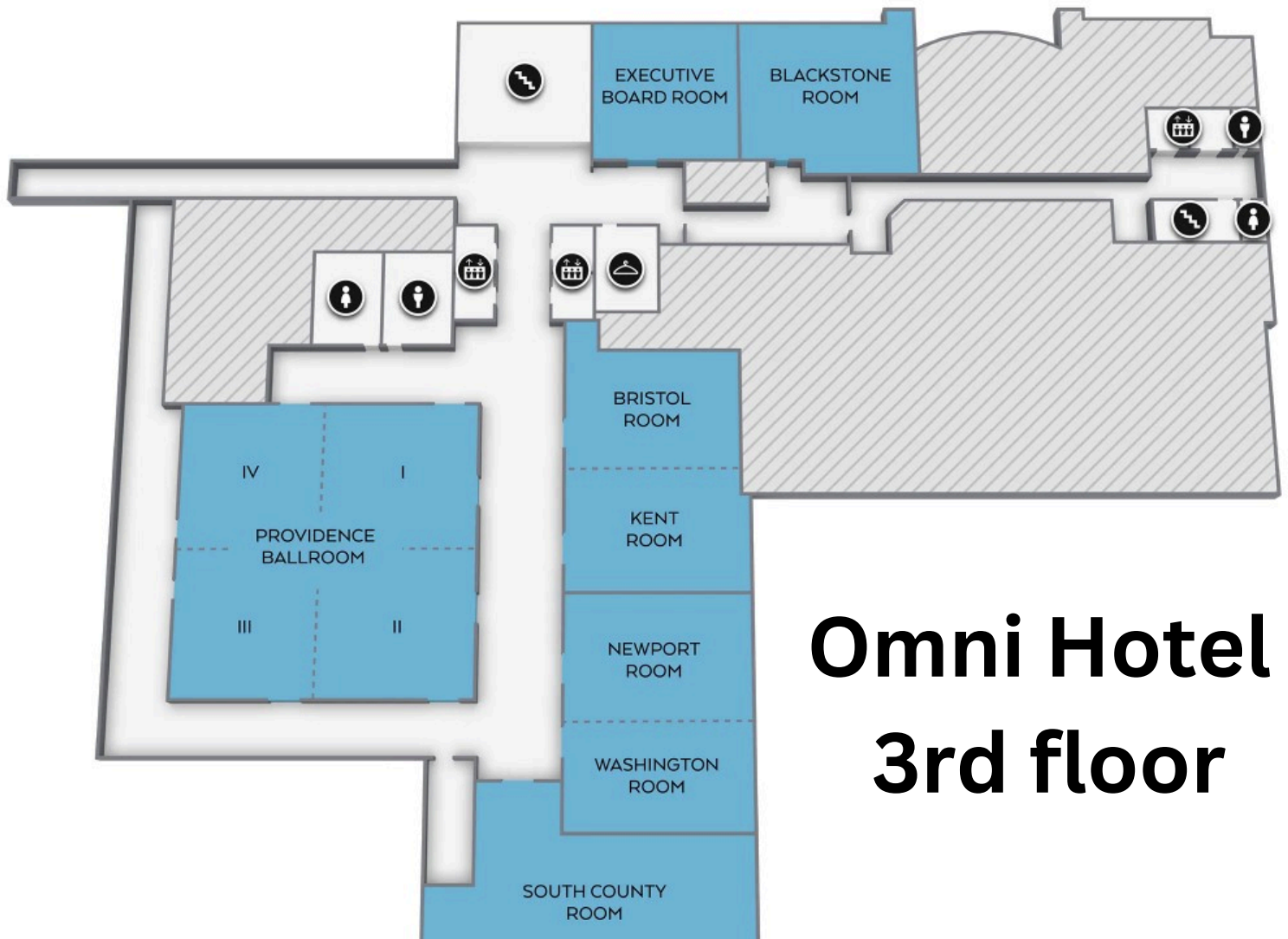

**Omni Hotel
3rd floor**

June 3-5, 2024

Providence, Rhode Island

Building a Culture of Collaboration



NORTHEAST EXTENSION
DIRECTORS

AGENDA

Monday, June 3

2:00 pm **Registration** Location: Providence Foyer

3:30 pm **Optional Tour:** Gotham Greens, Providence.

- Gotham Greens is a fresh food company farming with the future in mind. They build and operate sustainable greenhouses across America, growing delicious leafy greens and herbs that are always in season. While their farms are unconventional Gotham Greens is committed to taste, quality, and sustainability.

6:00 pm **Welcome Reception** Location: South County

Tuesday, June 4

7:00 am **Registration** Location: Providence Foyer

7:00 am **Breakfast** Location: South County

9:00 am **Welcome** Location: Newport/Washington

- *Presenter:* **John Kirby**, Dean, College of the Environment and Life Sciences, University of Rhode Island

9:15 am **Decision Making in a Community of Knowledge**

- *Presenter:* **Steven Sloman**, Professor of Cognitive, Linguistic, and Psychological Sciences, Brown University
 - Steven is a cognitive scientist who studies how people think. His work illuminates how our habits of thought influence the way we see the world, how the different systems that constitute thought interact to produce conclusions, conflict, and conversation, and how our construal of how the world works influences how we evaluate events and decide what actions to take. The focus of his research is collective cognition, how we think as a community, a topic elaborated in his book with Phil Fernbach, *The Knowledge Illusion: Why We Never Think Alone*.

10:30 am **Networking Break** Location: Providence Foyer

AGENDA

- 11:00 am **Perspectives in Leadership**
- *Presenter: **John Kirby**, Dean, College of the Environment and Life Sciences, University of Rhode Island and **Doug Steele**, Vice President, Food, Agriculture and Natural Resources (FANR), Association of Public and Land-grant Universities.*
 - This session is dedicated to understanding how effective leadership has played a role in helping our colleges, experiment stations, and Extension get to where they are today and identifying what leadership is needed to ensure that these units continue to contribute to the well-being of the lives, livelihoods, and landscapes of Northeast communities over the next 5, 10, 25, 50 years.
- 12:00 pm **Lunch** Location: South County
- 1:00 pm **Building a Blueprint for Collaboration**
- **Group Work Session**
 - This participatory session is designed to foster collective brainstorming, harnessing the insights derived from the Northeast Agenda, keynote presentations, and the reflections of academic leaders. We will leverage the wealth of expertise within our community to formulate robust strategies aimed at fostering collaboration across the Northeast region. Through participatory discussions and collaborative exercises, we will explore innovative approaches to strengthen partnerships, promote knowledge exchange, and facilitate interdisciplinary cooperation to pave the way for a brighter, more interconnected future in the Northeast.
- 2:30 pm **Networking Break** Location: Providence Foyer
- 3:00 pm **Filling the Resource Gaps: Opportunities for Collaboration**
- *Presenter: **Sara Eckhouse**, Executive Director, FoodShot Global*
 - FoodShot Global brings together a powerful partnership of world-class, mission-aligned venture funds, banks, corporations, foundations, universities, and non-profits. FoodShot Global's leadership provides a long-term vision for our global food future, and works collaboratively with partners to invest in that future.
- 4:30 pm **Meeting Summary and Action Steps**
- *Presenters: **Lisa Townson**, NEED Chair and Associate Dean, Extension and Agricultural Programs, University of Rhode Island and **Anton Bekkerman**, NERA Chair and Director, New Hampshire Agricultural Experiment Station, University of New Hampshire*
- 5:00 pm **Adjourn and Dinner on your own**

AGENDA

Wednesday, June 5

7:00 am **Breakfast** Location: South County

8:00 am **Section Meetings:**

- **NEED** Location: Bristol
- **NERA** Location: Kent
- **AHS & CARET** Location: Newport/Washington
- **Communicators** Location: Blackstone

10:00 am **Networking Break** Location: Providence Foyer

10:30 am **Section Meetings Continued**

11:00 am **Join Session** Location: Newport/Washington

12:00 pm **Lunch** Location: South County

1:00 pm **Reconvene** Location: Newport/Washington

- *Presenters:* **Lisa Townson**, NEED Chair and **Anton Bekkerman**, NERA Chair

2:00 pm **Meeting adjourned**

Announcements

SCAN ME



Providence Restaurants



www.nerasaes.org